

2-#6 (3/4") EPOXY-COATED  
SMOOTH DOWEL BARS  
WITH GREASED CAPS  
ARE TO BE INSTALLED  
AT ALL EXPANSION JOINTS

3" THICK COMPACTED  
CA-6 STONE BASE

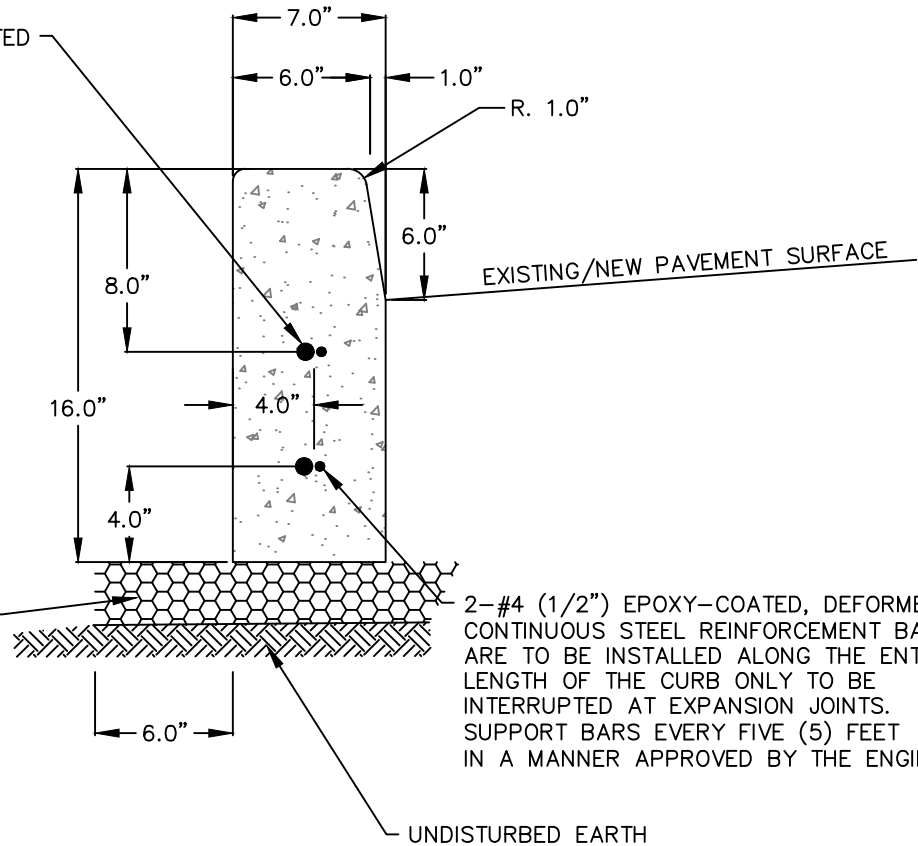

2-#4 (1/2") EPOXY-COATED, DEFORMED,  
CONTINUOUS STEEL REINFORCEMENT BARS  
ARE TO BE INSTALLED ALONG THE ENTIRE  
LENGTH OF THE CURB ONLY TO BE  
INTERRUPTED AT EXPANSION JOINTS.  
SUPPORT BARS EVERY FIVE (5) FEET  
IN A MANNER APPROVED BY THE ENGINEER

UNDISTURBED EARTH

#### NOTES:

1. EXPANSION JOINTS ARE TO BE CONSTRUCTED AT 60' INTERVALS WITH 3/4" FIBER EXPANSION JOINT PER ASTM D-1751, AND AT ADDITIONAL LOCATIONS AS SPECIFIED BY THE ENGINEER.
2. CONTRACTION JOINTS ARE TO BE CONSTRUCTED AT 15' INTERVALS AND AT ADDITIONAL LOCATIONS AS SPECIFIED BY THE ENGINEER

## TYPE B CURB DETAIL